



Interlibrary Loan Users Panel: Archaeology & Astronomy in Maya Temple Precincts

Anne S. Dowd, Ph.D.
National Park Service

April 19, 2018
49th Annual Colorado ILL Conference,
Colorado State University, Fort Collins, Colorado

Calakmul Main Plaza, Mexico, E Group Architectural Complex

Image courtesy of William Folan



Uaxactún, Guatemala, Group E Architectural Complex

Image courtesy of Aveni & Dowd (2017)

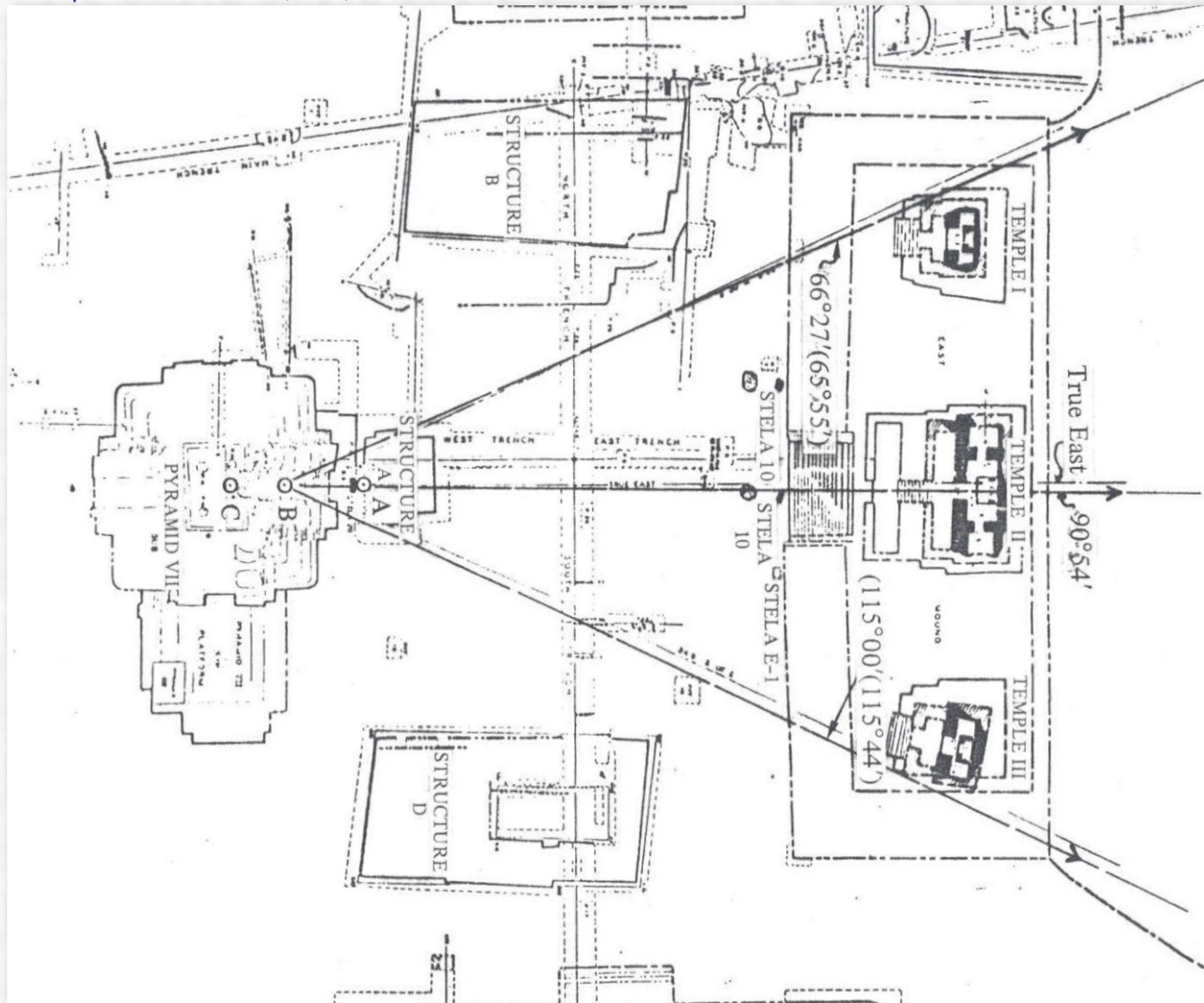

2) Central places, e.g., Calakmul's Structure IVb, East side of Main Plaza (Castillo et al. 2007:59).



3) Time depth, construction and use roughly between 1,000 BC-AD 1,000, table showing southern Mesoamerican chronology (Inomata et al. 2013: Fig. 2).

Period	Cal. BC	San Lorenzo/ La Venta	Chiapa de Corzo	Southern Pacific Coast	Ceibal	Political processes and construction events
Preclassic	Late	Zapote	Guanacaste	Guillén	Cantutse 2	<p>La Venta as a major center</p> <p>Spread of E-Group assemblages in the Maya lowlands</p> <p>Tikal and Cival E-Group assemblages</p> <p>Spread of MFC patterns in central Chiapas</p> <p>Ceibal pyramid and monumental construction</p> <p>La Blanca pyramid?</p> <p>Ceibal E-Group assemblage</p> <p>Ojo de Agua plaza-pyramid complex</p> <p>Transitional period</p>
			Francesa	Frontera	Escoba 3	
	Middle	Late Franco	Escalera	Escalón	Escoba 2	
					Escoba 1	
		Early Franco	Vista Hermosa	Late Conchas	Escoba 3	
					Escoba 1	
		Late Puente	Dili	Early Conchas	Real 2	
					Real 1	
		Early Puente	Cotorra	Jocotal	Real 1	
					Real 1	
Early	San Lorenzo		Cuadros	Real 1		
				Real 1		

Historiography of E Group Research:

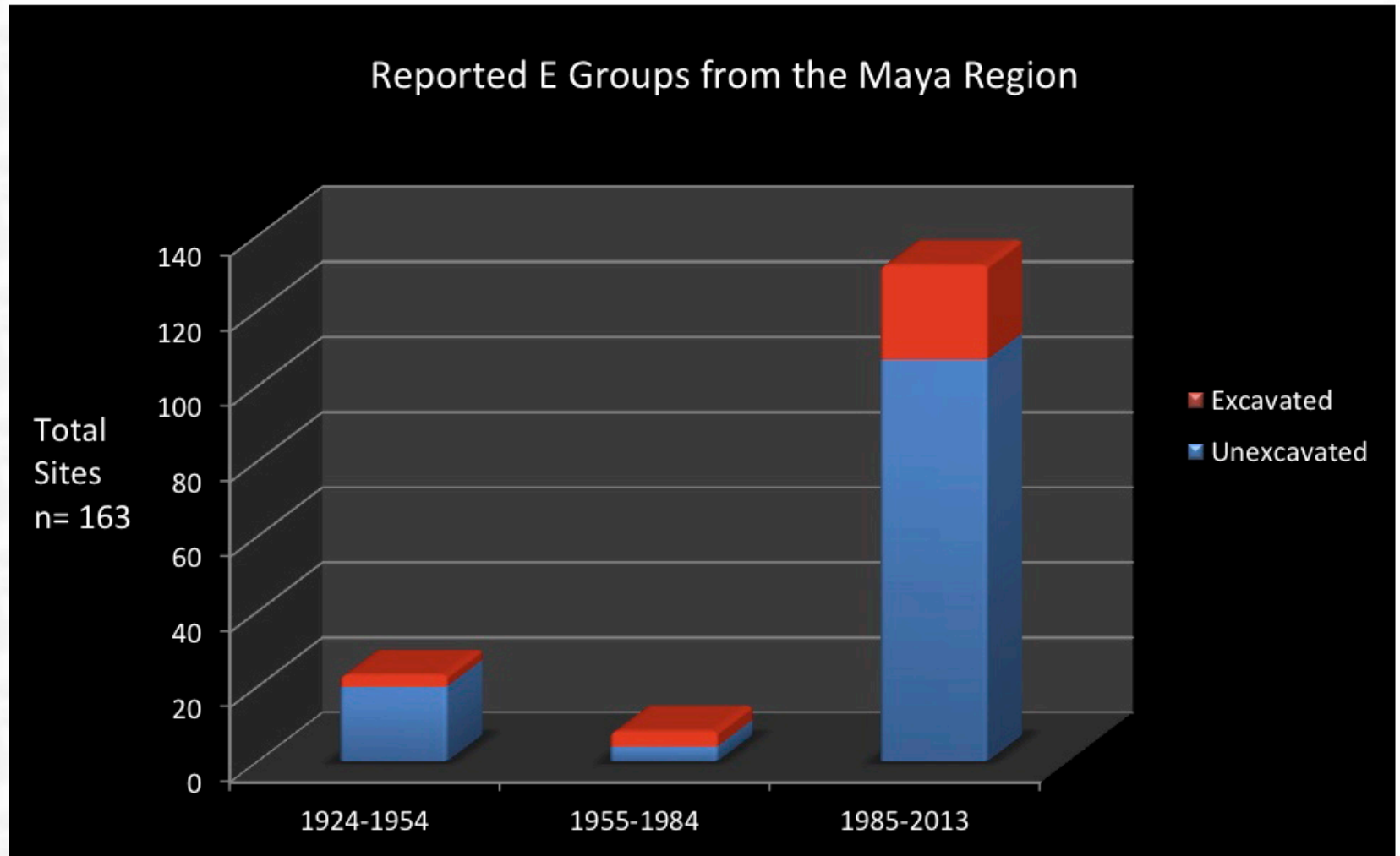

E Group Excavation Timeline:

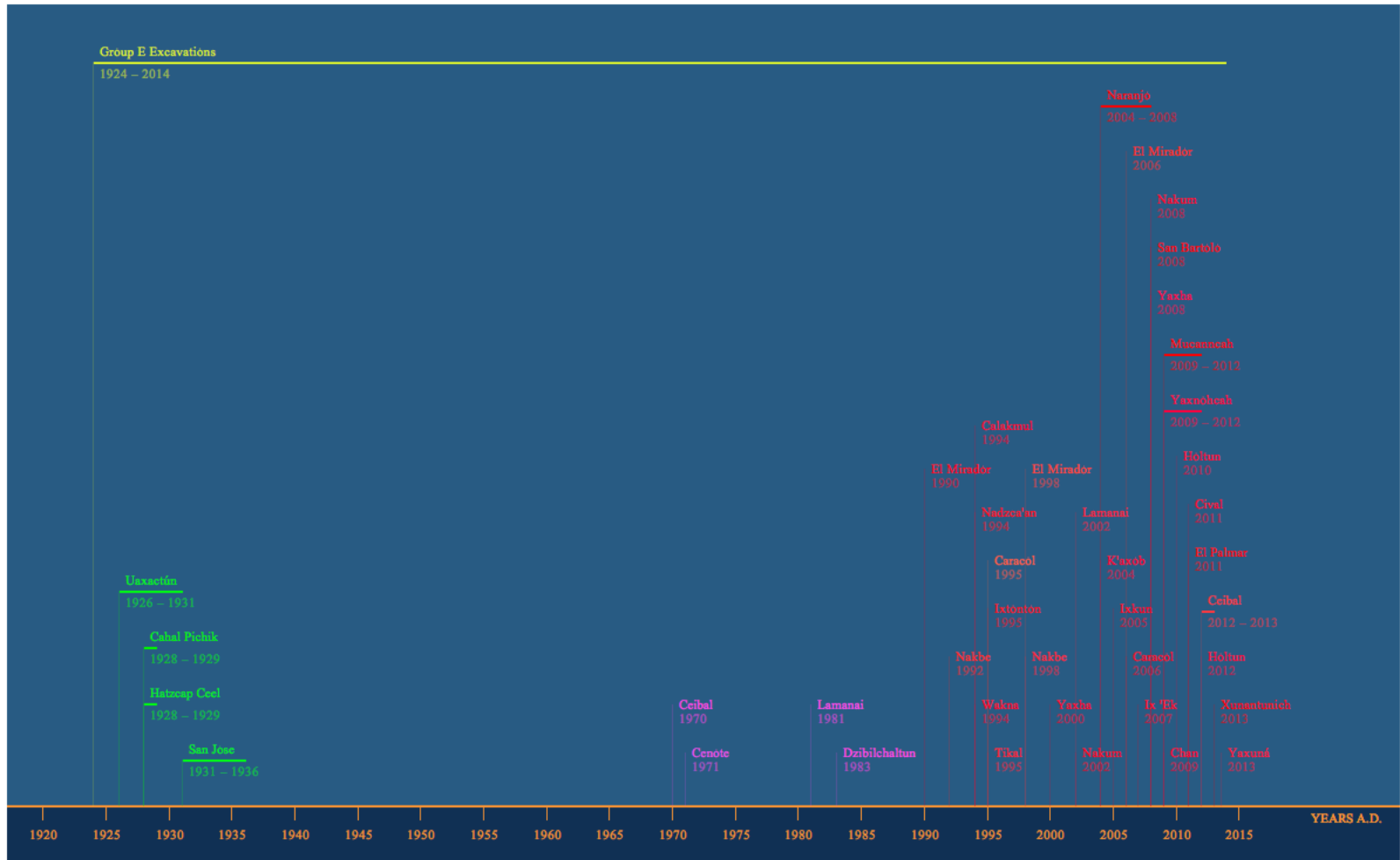

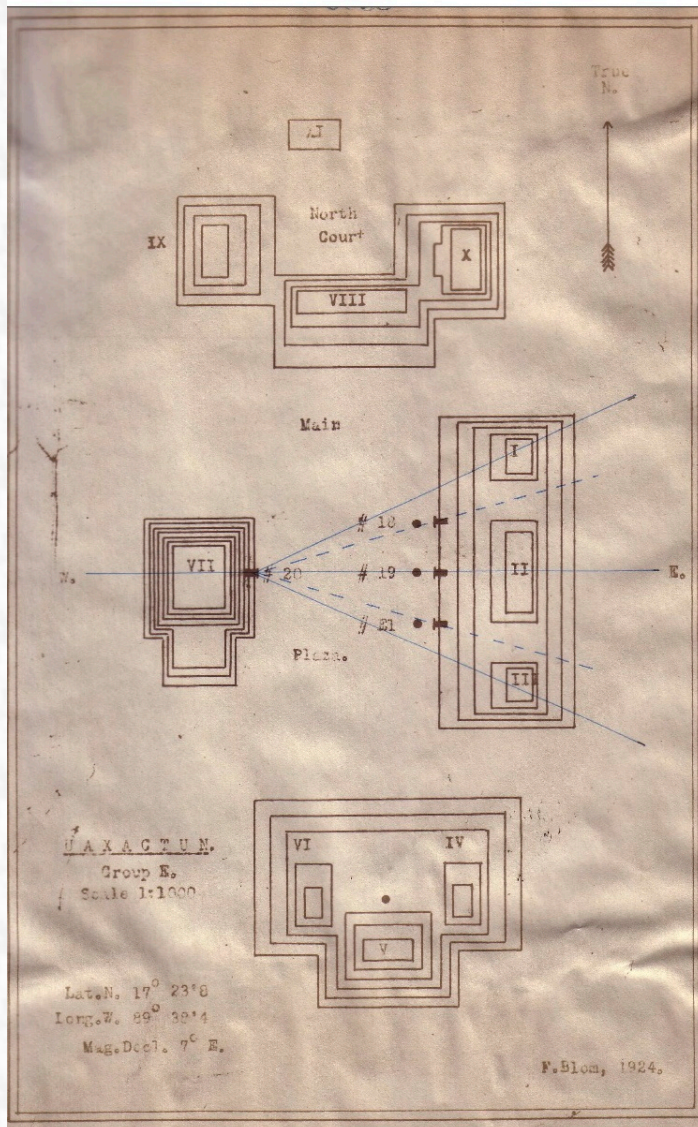

Uaxactún Group E Plan
(Blom 1924:58).

Ruppert (1977[1940]:222) wrote: "Since the small buildings on the east side of the plaza are definitely not domiciliary and the pyramid on the west does not support a building the arrangement must be ceremonial or esoteric in function."

C.I.W. excavations at Uaxactún Group E Plaza from Str. X, view south

Copyright © 2009, Harvard University Trustees and Fellows



ca., 1926-1930

Emergence of religious institutions:

Multi-room temples: Calakmul

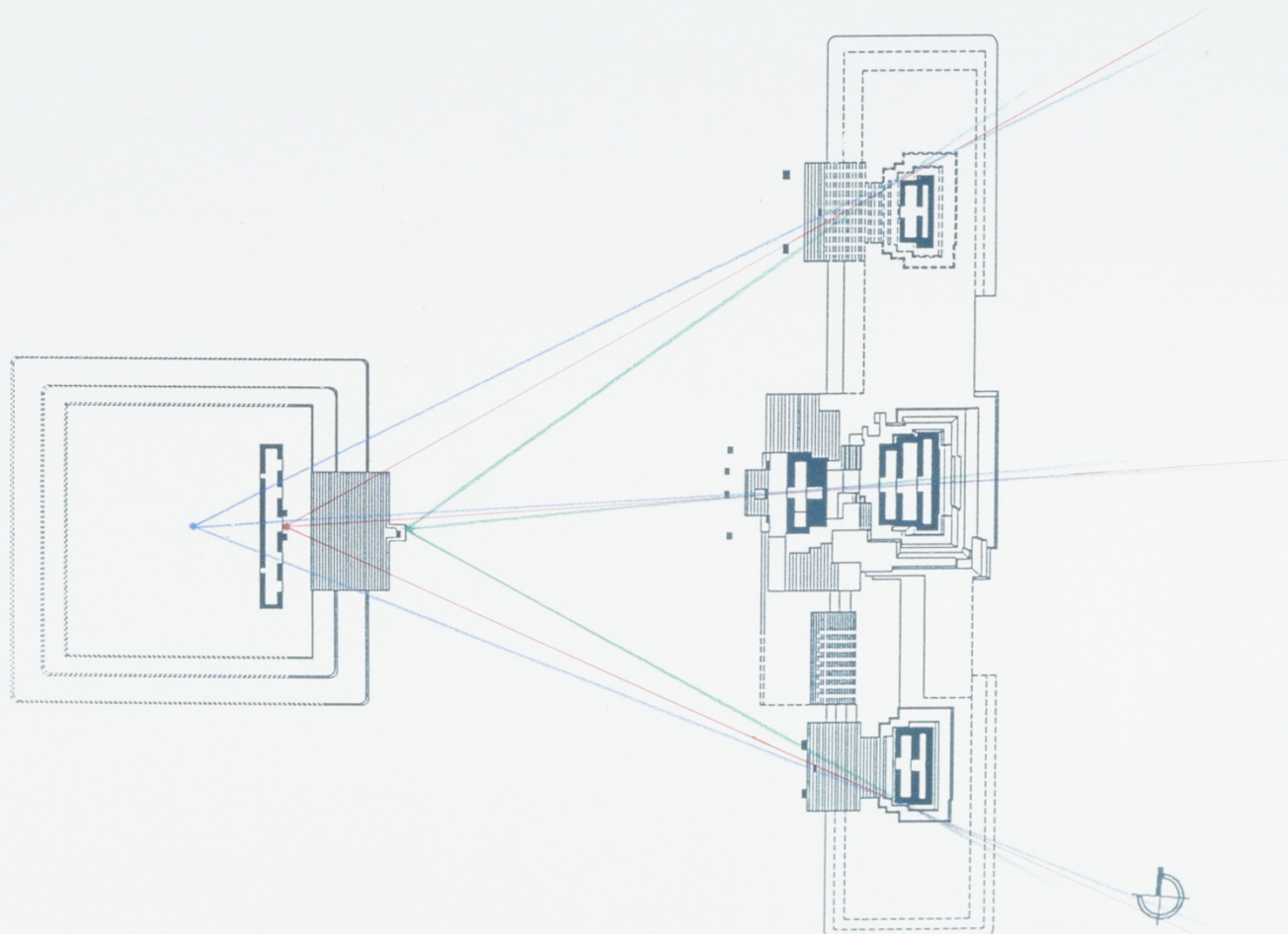

Map, E. González

Emergence of religious institutions:

Multi-room temples: Calakmul



Photo, Dowd © 1994

Emergence of religious institutions:

Multi-room temples: Calakmul



Photo, Dowd © 1995

Emergence of religious institutions: Multi-room temples: Uaxactún

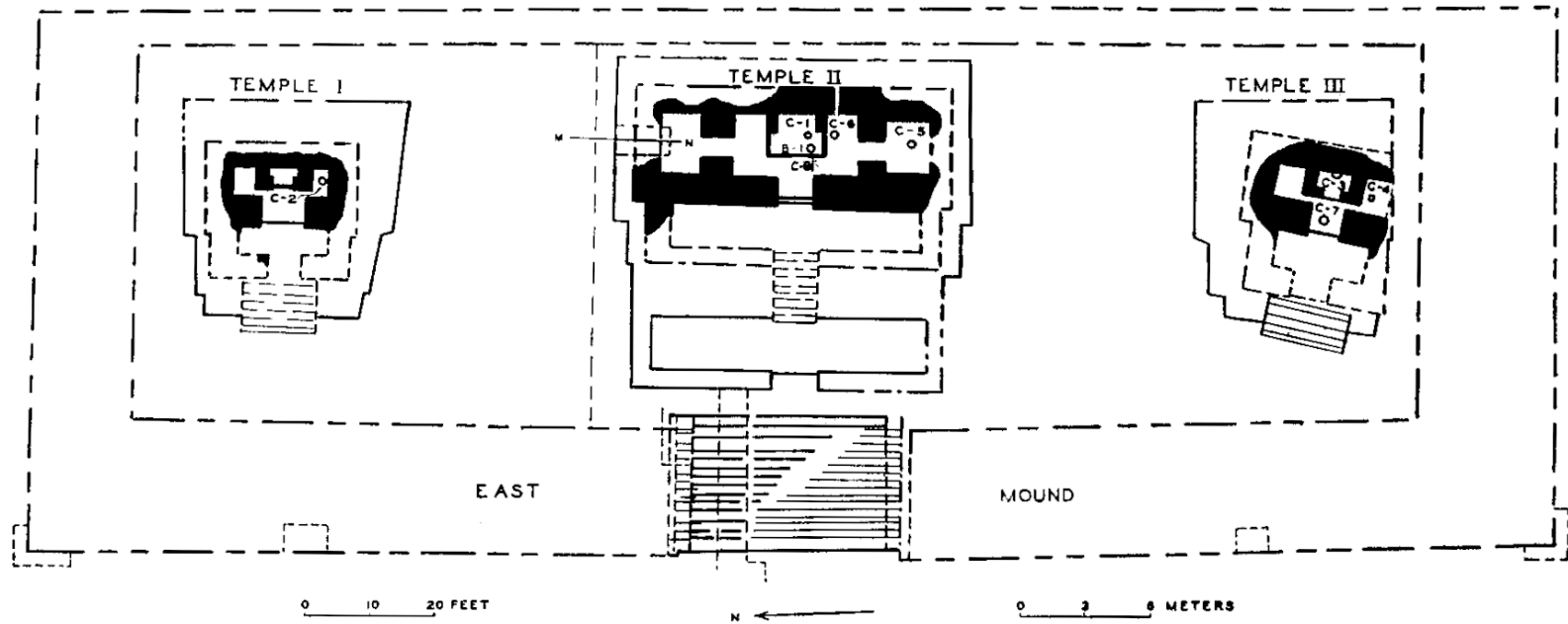

(Ricketson & Ricketson 1937)

Emergence of religious institutions:

Multi-room temples: Hatzcap Ceel ('Cold Dawn') (Thompson 1931)

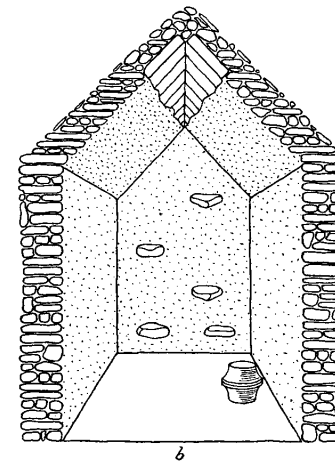
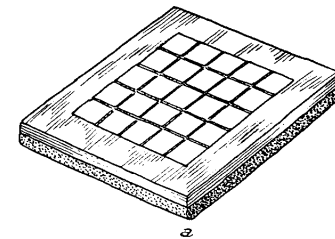
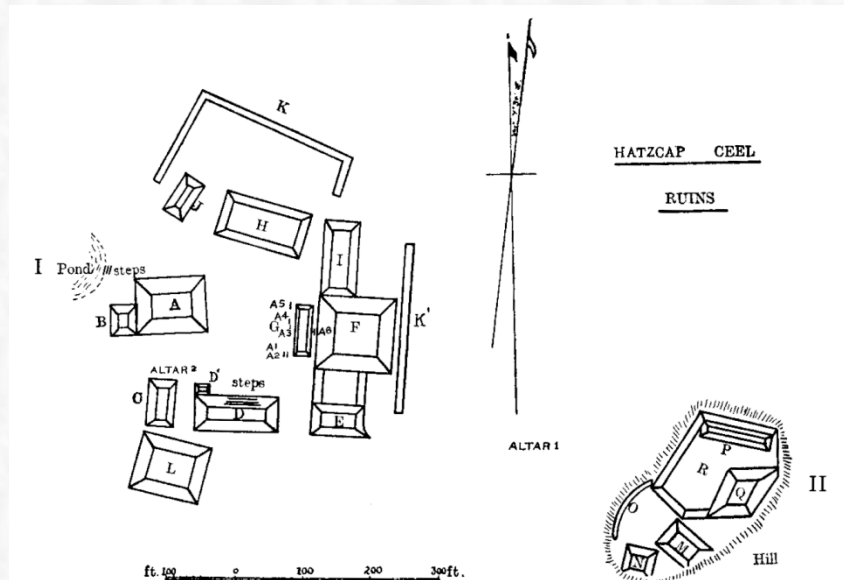

Religious specialization:

Single-room temples: Cahal Pichik ('The Town of the Emerald Toucanets')
(Thompson 1931)

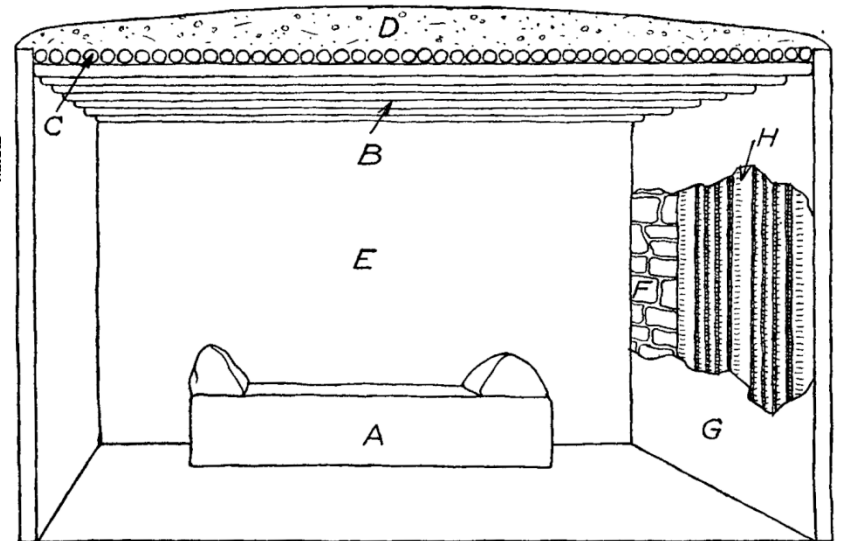
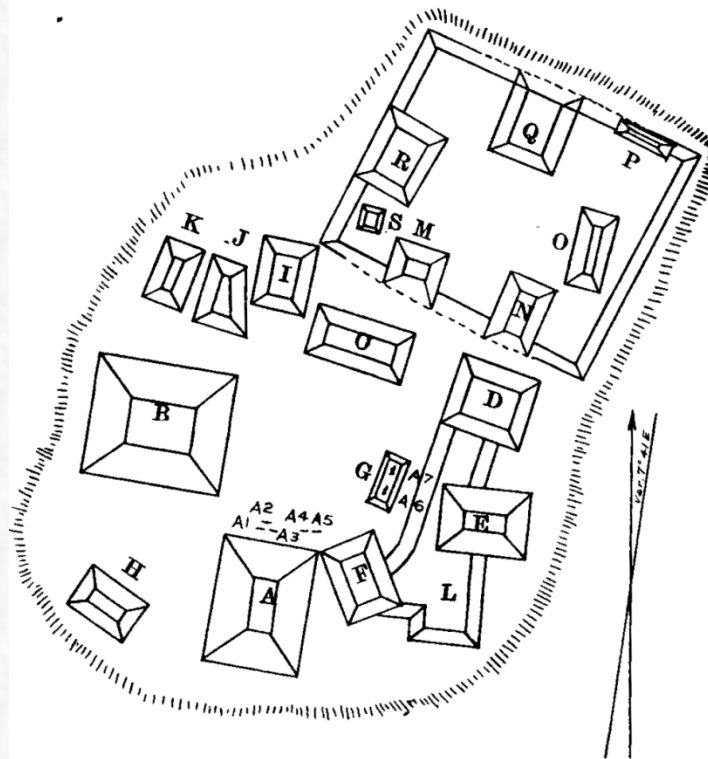

Religious specialization:

Single-room temples: San Jose (Thompson 1939)

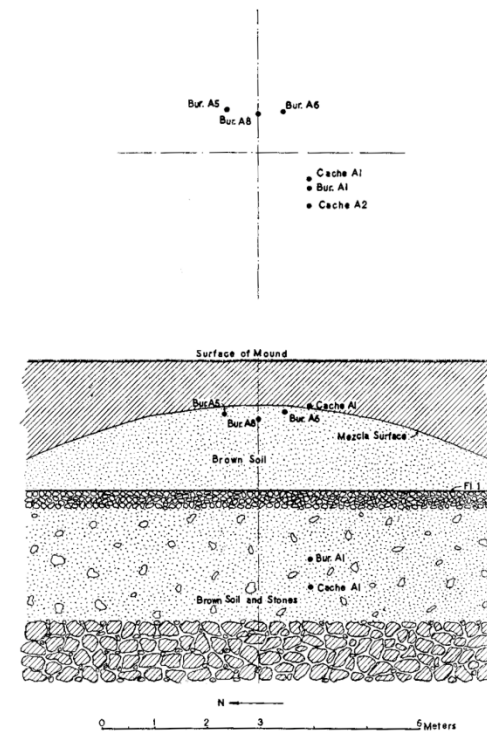
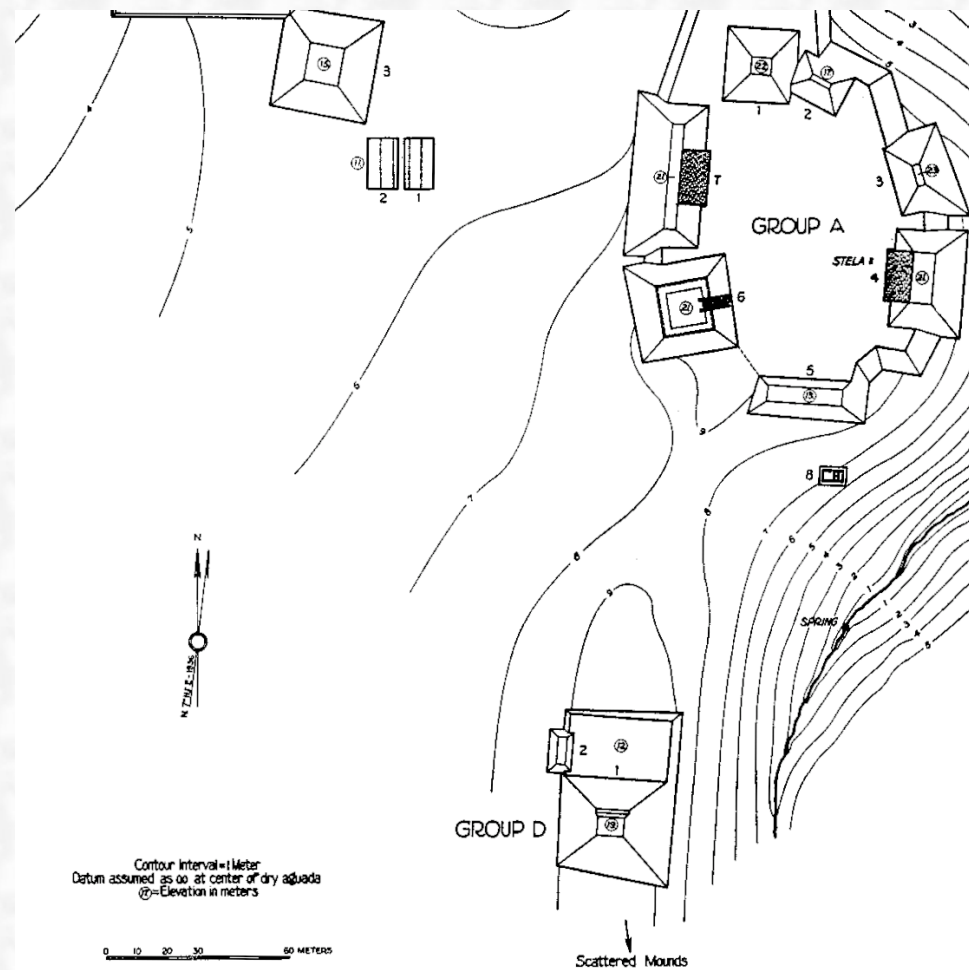

Site 48FR2254, Because we may not have many chances to see emerging inequalities in the region due to preservation issues, we might look to other examples where a religious practitioner like a shaman is responsible for subsistence and the specialized architecture accompanying this role.

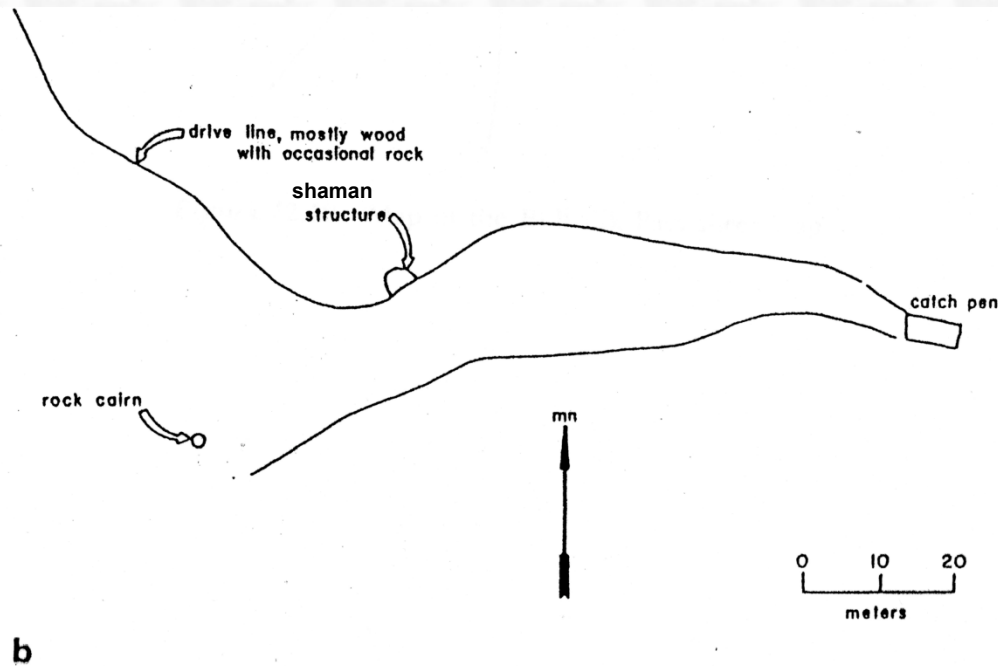

e.g., shaman huts built into big horn sheep traps



Photos, Dowd © 2013



Site 48FR2253, ca. A.D. 1800, Shoshone, consider George Frison's recent statement, "I think people underestimate the amount of ritual activity that goes on with this kind of thing," speaking about the function of "shaman huts" built into Wind River Range bighorn sheep traps (personal communication, 2013).

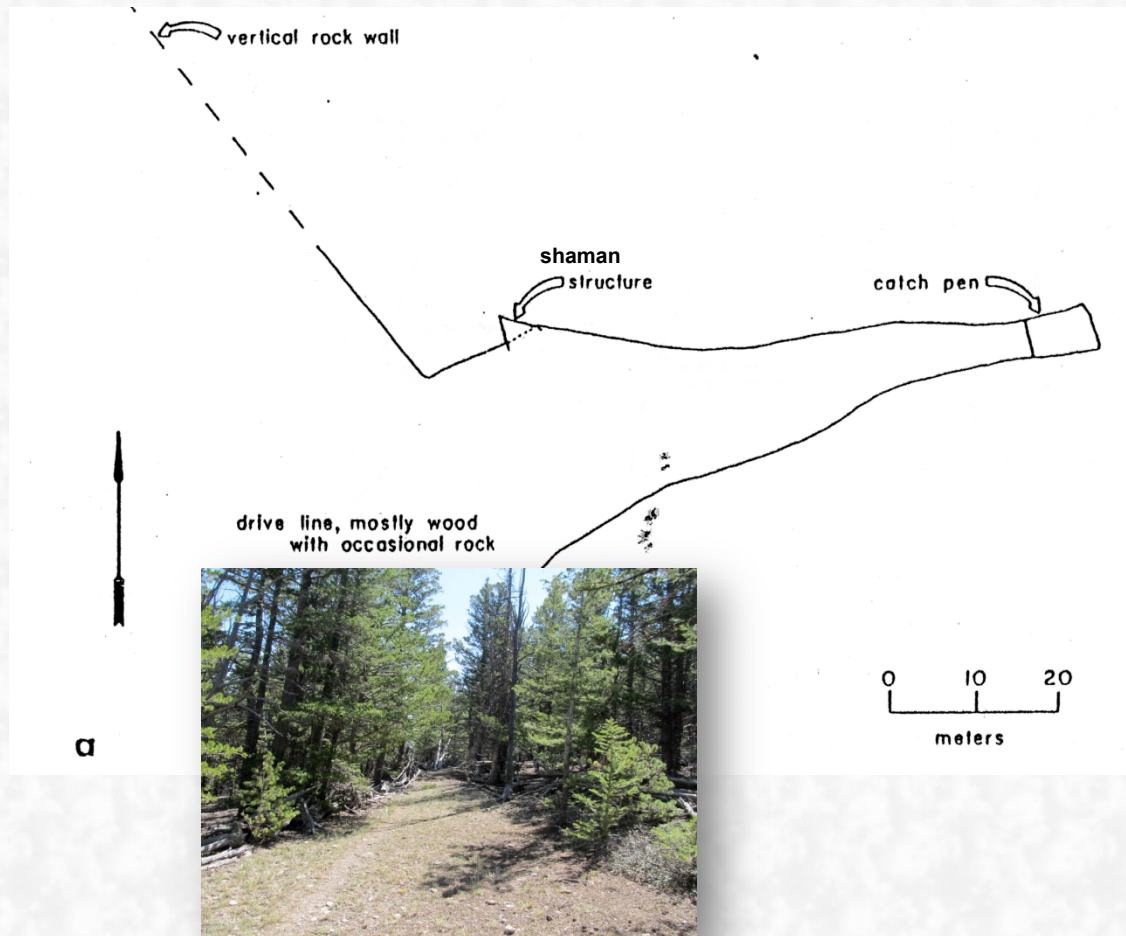

Six areas of primary state formation (value in studying secondary state formation in nearby areas):

- 1) Oaxaca (Monte Alban), Mexico,
- 2) Viru-Gallinazo/Moche, Peru,
- 3) Uruk, Mesopotamia (Iran),
- 4) Hierakonpolis, Upper Nile, Egypt,
- 5) Harrapa, Indus Valley, Pakistan; and,
- 6) Erlitou, Yilou Basin, China.



Scale 1:134,000,000
Robinson Projection
standard parallels 38°N and 38°S

January 2002

Boundary representation is
not necessarily authoritative.

802804AI (R00352) 12-01



Future Work

- Where to dig next?
- What do we hope to find?
- How is our work richer and more meaningful with the assistance we get from librarians?
- Interlibrary Loans (ILL) bring resources directly to patrons and create competitive academic environments at local libraries.